

Specifications

Typical Capacity (mAh)		11000
Nominal Capacity (mAh)		10600
Nominal Voltage @0.2C (V)		3.6
Approx. Weight (g)		136±4g
AC-Impedance at 1KHz (mΩ)		≤ 3.0
Dimensions	Thickness (mm)	7.4±0.4
	Width (mm)	70.5±1.0
	Length (mm)	124.5±1.0
Nominal (Typical) Charge Condition	Current (C/A)	0.2C/2.2A
	Voltage (V)	4.20
	Cut-off Current	0.02C/220mA
	Ending Time (h)	6
Max.Charge Current (C/A)		1C/11.0A
Nominal Discharge	Current (C/A)	1C/11.0A
	Cut-off Voltage (V)	2.5
Max Discharge Current	Continuous (C/A)	15C/165.0A
	Burst (C/A)	20C/220.0A
Ambient Temperature	Charge	0°C~10°C 0.2C Charge 10°C~20°C 0.5C Charge 20°C~35°C 1.0C Charge 35°C~45°C 0.5C Charge
	Discharge	-20~60°C
	Storage	≤ 1month
> 1months		-20~30°C
Limit Temperature	Charge	0°C~55°C (Cell Surface Temperature)
	Discharge	-20°C~85°C (Cell Surface Temperature)

Dimensions(mm)

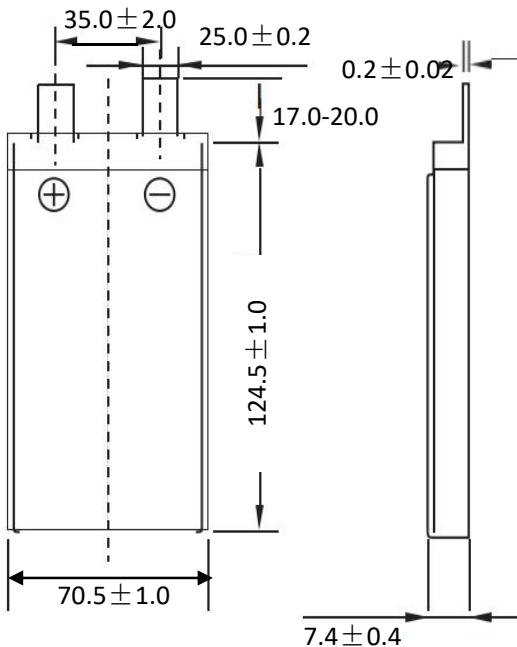

Charge Characteristics

Charge: 1C mA, 4.2V, 78min, 0.02C mA Cut-off (CC/CV)
Charge Temperature: 25±2°C

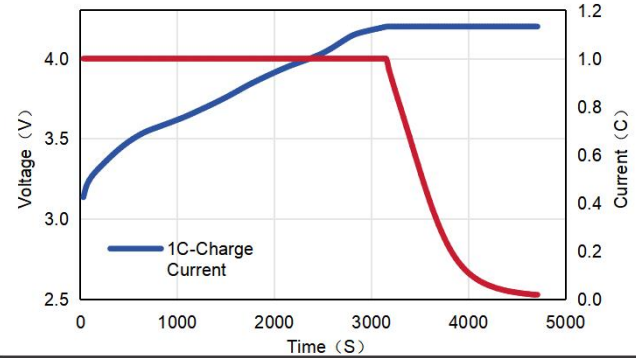

Discharge Rate Characteristics

Charge: 1 C mA, 4.20 V 0.02 C mA Cut-off (CC/CV)
Discharge: 1C, 3C, 5C, 10C, 12C, 15C mA, 2.50 V Cut-off
Temperatur: 25 ± 2 °C

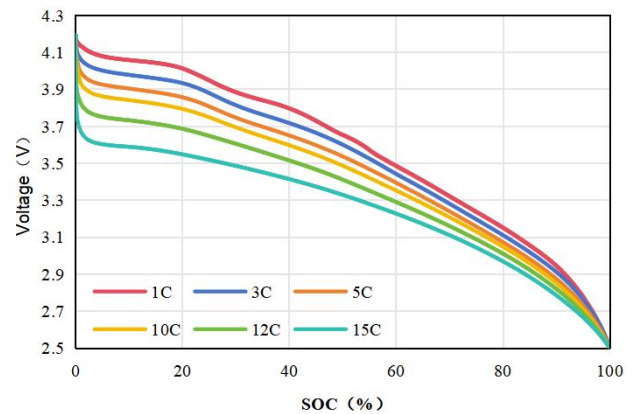

Cycle Life Characteristics

Charge: 1 C mA, 4.20 V 0.02 C mA Cut-off (CC/CV)
Discharge: 6C mA, 2.50 V Cut-off
Temperatur: 25± 2 °C

