

Specifications

Typical Capacity (mAh)		16700	
Nominal Capacity (mAh)		16000	
Nominal Voltage @0.2C (V)		3.6	
Approx. Weight (g)		206±6g	
AC-Impedance at 1KHz (mΩ)		≤ 2.5	
Dimensions	Thickness (mm)	11.2±0.4	
	Width (mm)	70.5±1.0	
	Length (mm)	124.5±1.0	
Nominal (Typical) Charge Condition	Current (C/A)	0.2C/3.34A	
	Voltage (V)	4.20	
	Cut-off Current	0.02C/334mA	
	Ending Time (h)	6	
Max.Charge Current (C/A)		1C/16.7A	
Nominal Discharge	Current (C/A)	1C/16.7A	
	Cut-off Voltage (V)	2.5	
Max Discharge Current	Continuous (C/A)	15C/250.5A	
	Burst (C/A)	20C/334.0A	
Ambient Temperature	Charge	0°C~10°C 0.2C Charge	
		10°C~20°C 0.5C Charge	
		20°C~35°C 1.0C Charge 35°C~45°C 0.5C Charge	
Storage	Discharge	-20~60°C	
		≤ 1month	-20~45°C
		> 1months	-20~30°C
Limit Temperature	Charge	0°C~55°C (Cell Surface Temperature)	
	Discharge	-20°C~85°C (Cell Surface Temperature)	

Dimensions(mm)

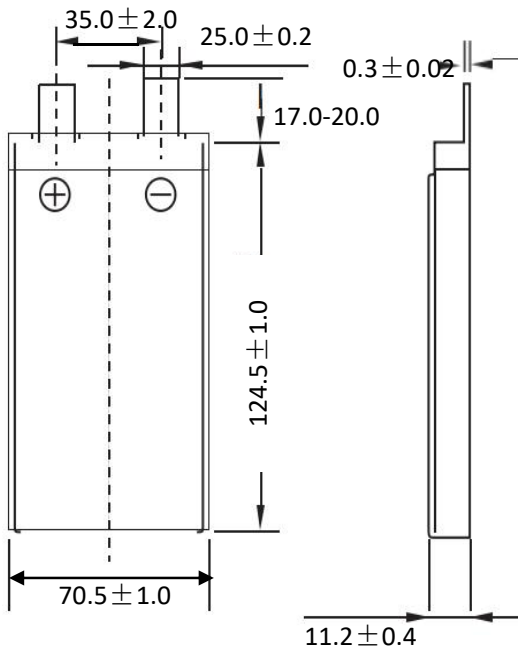

Charge Characteristics

Charge: 1C mA, 4.2V, 78min, 0.02C mA Cut-off (CC/CV)
Charge Temperature: 25±2°C

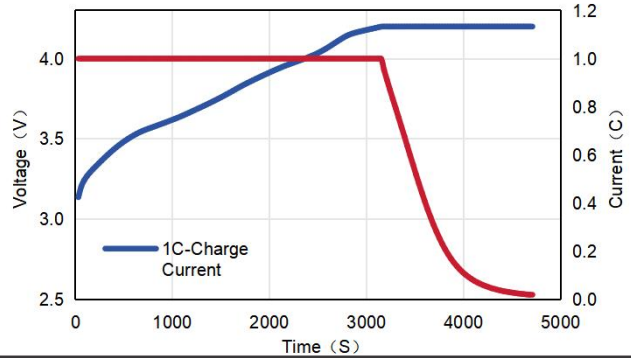

Discharge Rate Characteristics

Charge: 1 C mA, 4.20 V 0.02 C mA Cut-off (CC/CV)
Discharge: 1C, 3C, 5C, 10C, 12C, 15C mA, 2.50 V Cut-off
Temperatur: 25 ± 2 °C

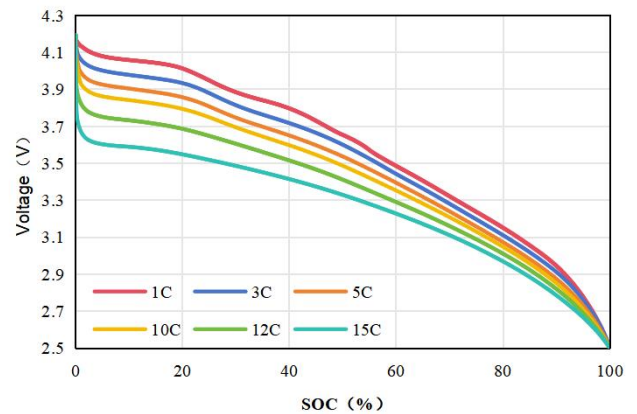

Cycle Life Characteristics

Charge: 1 C mA, 4.20 V 0.02 C mA Cut-off (CC/CV)
Discharge: 6C mA, 2.50 V Cut-off
Temperatur: 25 ± 2 °C

