

Specifications

Typical Capacity (mAh)		15000
Nominal Capacity (mAh)		14400
Nominal Voltage @0.2C (V)		3.6
Approx. Weight (g)		187±6g
AC-Impedance at 1KHz (mΩ)		≤ 2.5
Dimensions	Thickness (mm)	10.2±0.4
	Width (mm)	70.5±1.0
	Length (mm)	124.5±1.0
Nominal (Typical) Charge Condition	Current (C/A)	0.2C/3.0A
	Voltage (V)	4.20
	Cut-off Current	0.02C/300mA
	Ending Time (h)	6
Max.Charge Current (C/A)		1C/15.0A
Nominal Discharge	Current (C/A)	1C/15.0A
	Cut-off Voltage (V)	2.5
Max Discharge Current	Continuous (C/A)	15C/225.0A
	Burst (C/A)	20C/300.0A
Ambient Temperature	Charge	0°C~10°C 0.2C Charge
		10°C~20°C 0.5C Charge
		20°C~35°C 1.0C Charge
Storage	≤ 1month	-20~45°C
	> 1months	-20~30°C
Limit Temperature	Charge	0°C~55°C (Cell Surface Temperature)
	Discharge	-20°C~85°C (Cell Surface Temperature)

Charge Characteristics

Charge: 1C mA, 4.2V, 78min, 0.02C mA Cut-off (CC/CV)
Charge Temperature: 25±2°C

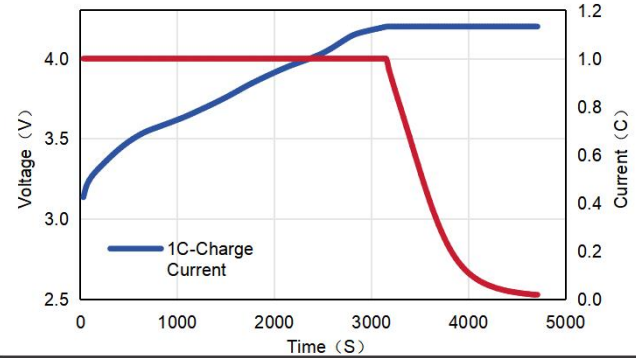

Discharge Rate Characteristics

Charge: 1 C mA , 4.20 V 0.02 C mA Cut-off (CC/CV)
Discharge: 1C, 3C, 5C, 10C, 12C, 15C mA , 2.50 V Cut-off
Temperatur: 25 ± 2 °C

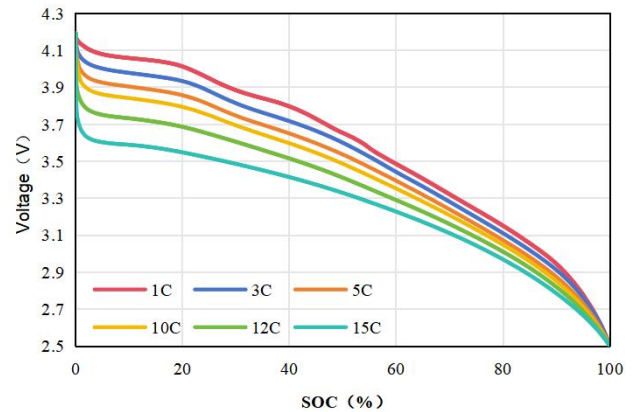

Dimensions(mm)

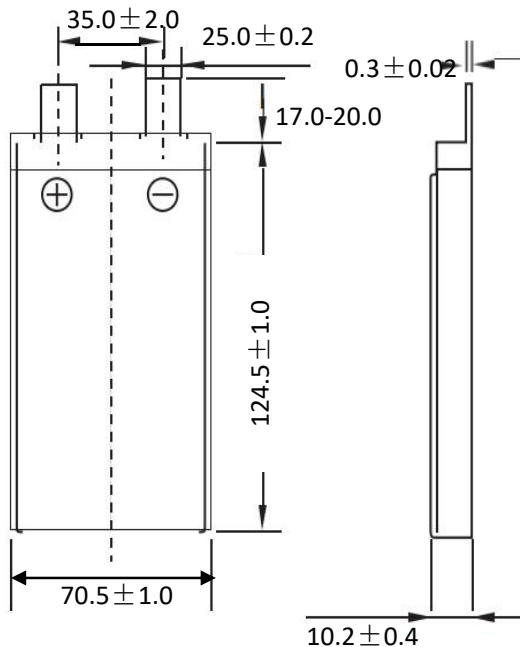

Cycle Life Characteristics

Charge: 1 C mA , 4.20 V 0.02 C mA Cut-off (CC/CV)
Discharge: 6C mA , 2.50 V Cut-off
Temperatur: 25 ± 2 °C

